

5073 Banks

Stainless steel lever handle

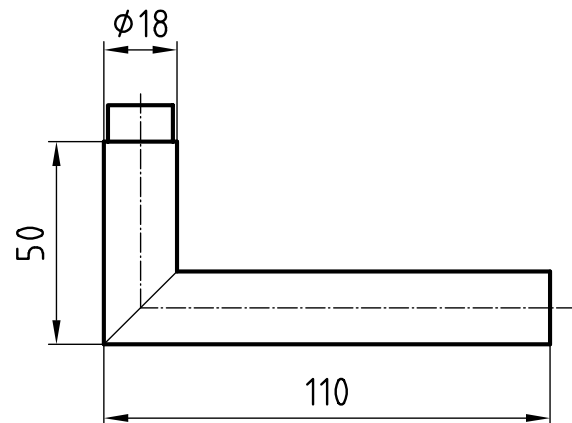
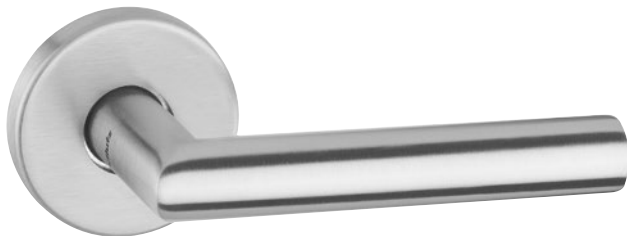

Picture shows handle with 5620C rose

Product profile

Residential construction

Standard version

Satin stainless steel surface

Lever handle length 110 mm, Ø 18 mm

Projection 50 mm

Prepared for fixed mobile mounting with easyfix

Steel galvanised square spindle

16-mm Glutz glide bearing, tested for 2.5 million cycles

Important note

To achieve usage class 4 in accordance with EN 1906, a 9-mm steel or 8-mm stainless steel square spindle is needed

5073 · 1 · 2 · 3 · 4 · 5 · 6

1 Execution	2 Guide	3 Spindle	4 Bolt length	5 Spindle material	6 Surface
00 Lochteil	0 glide	80 8 mm	00 Without	0 Without	00 Stainless steel matt
10 Stifftteil		85 8,5 mm	06 84 mm	1 Galvanized steel	11 Stainless steel polished
50 Paar		90 9 mm	12 109 mm	2 Stainless steel	44 Antibacterial
			99 Auf Anfrage		51 RAL 9005 black matt
					99 On request